

APPLEWOOD SANITATION DISTRICT BOUNDARY MAP

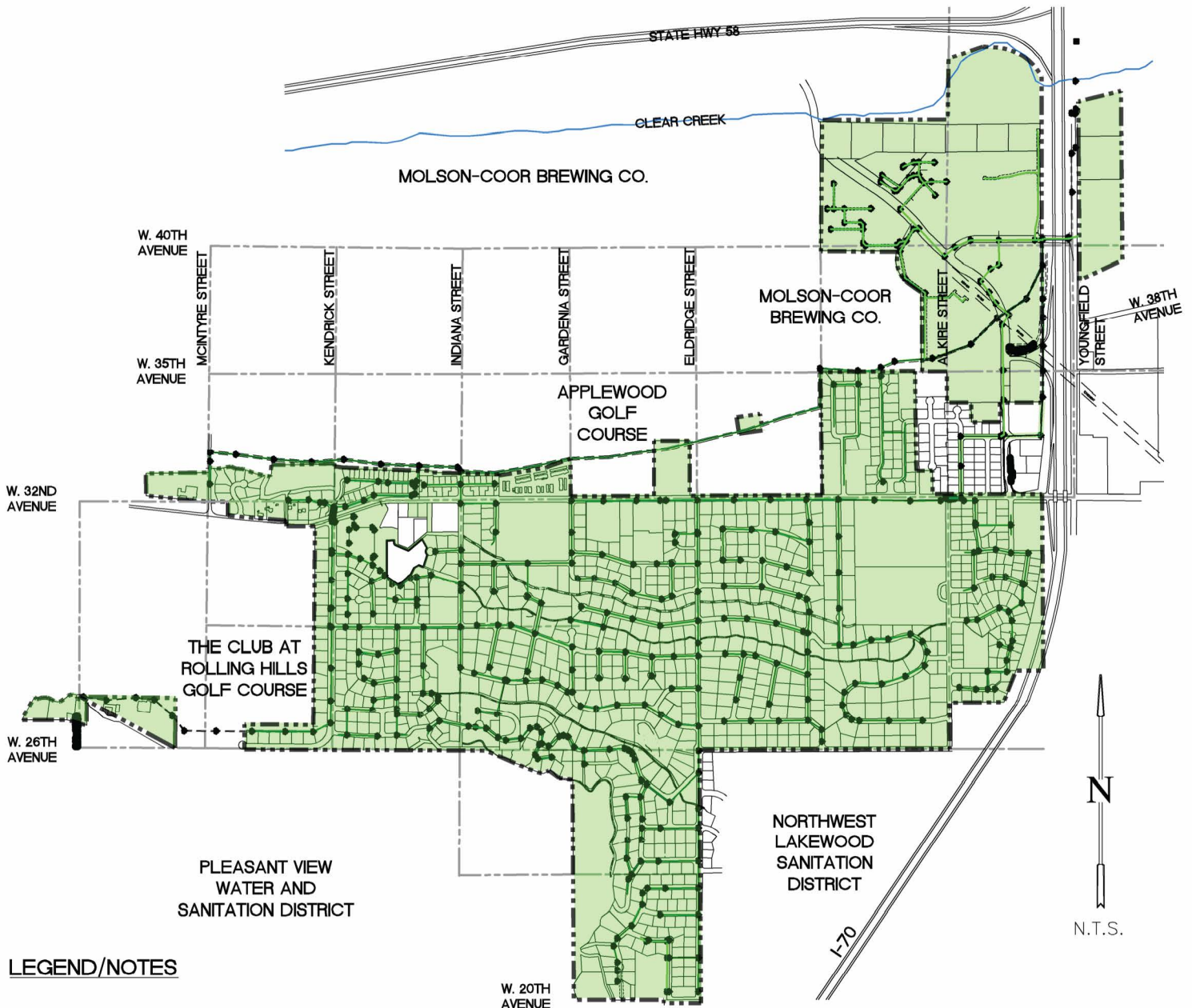

LEGEND/NOTES

- DISTRICT BOUNDARY
- DISTRICT MAINS
- GRID

DISTRICT DATA

AREA	777.6 Acres
POPULATION	* 4,350 Persons
LENGTH OF SEWER LINE	98,579 feet, 18.7 miles
NUMBER OF MANHOLES	468
NUMBER OF CONNECTIONS	1,386
NUMBER OF EQUIV. RES. UNITS	January, 2024

THE DISTRICT INCLUDES PART OF THE FOLLOWING SECTIONS: SEC. 20, 29, 30 + 31, T3S, R69W AND SEC. 25, T3S, R70W

*POPULATION BASED ON 2.5 RESIDENTS PER ADDRESS

