

# APPLEWOOD SANITATION DISTRICT BOUNDARY MAP

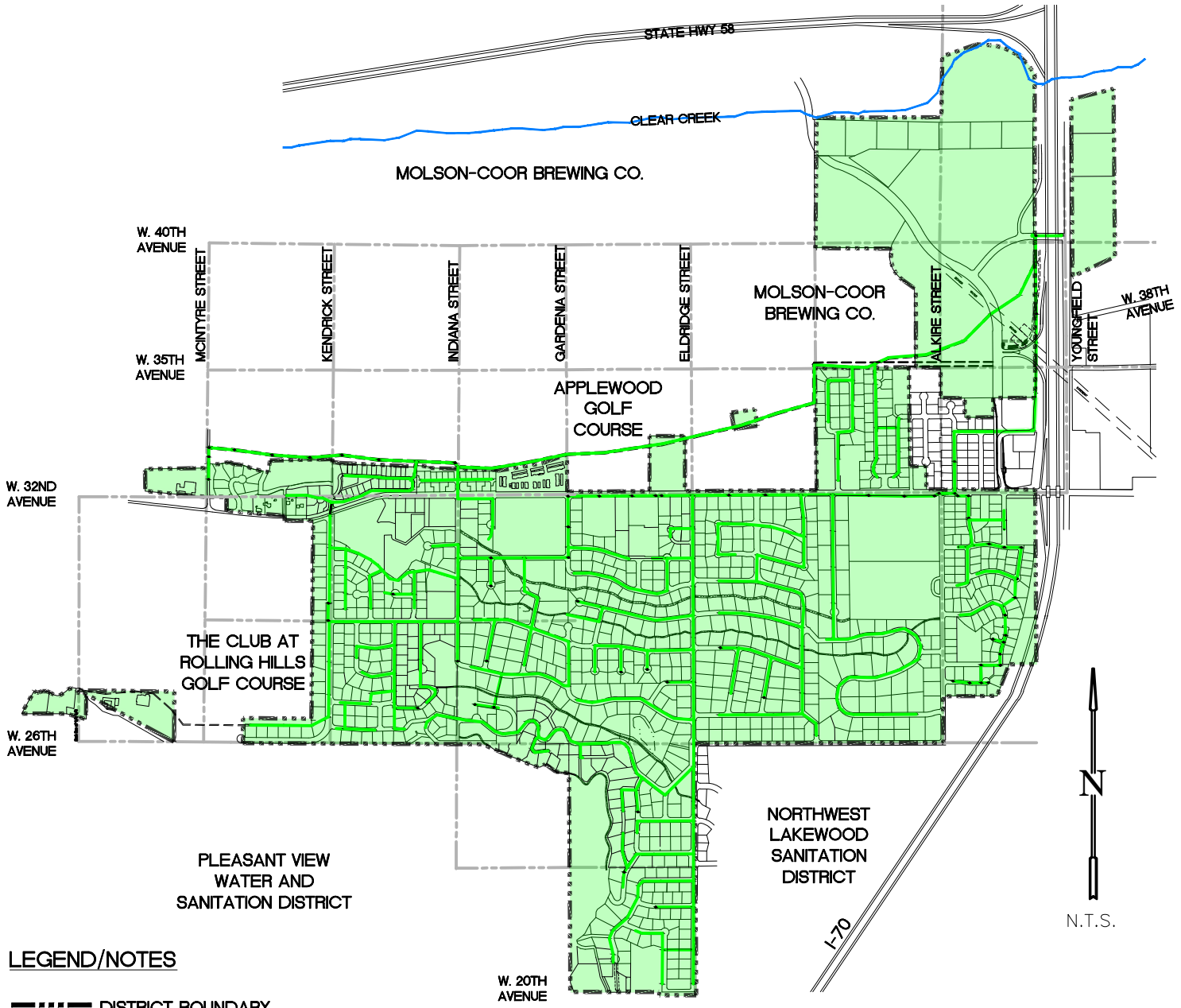

## LEGEND/NOTES

- DISTRICT BOUNDARY
- DISTRICT MAINS
- GRID

## DISTRICT DATA

AREA	777.6 Acres
POPULATION	* 3,310 Persons
LENGTH OF SEWER LINE	90,760 feet, 17.19 miles
NUMBER OF MANHOLES	396
NUMBER OF CONNECTIONS	1,336
NUMBER OF EQUIV. RES. UNITS	3,326
CURRENT AS OF	December, 2020

THE DISTRICT INCLUDES PART OF THE FOLLOWING SECTIONS: SEC. 20, 29, 30 + 31, T3S, R69W AND SEC. 25, T3S, R70W

\*POPULATION BASED ON 2.5 RESIDENTS PER ADDRESS