

APPLEWOOD SANITATION DISTRICT BOUNDARY MAP

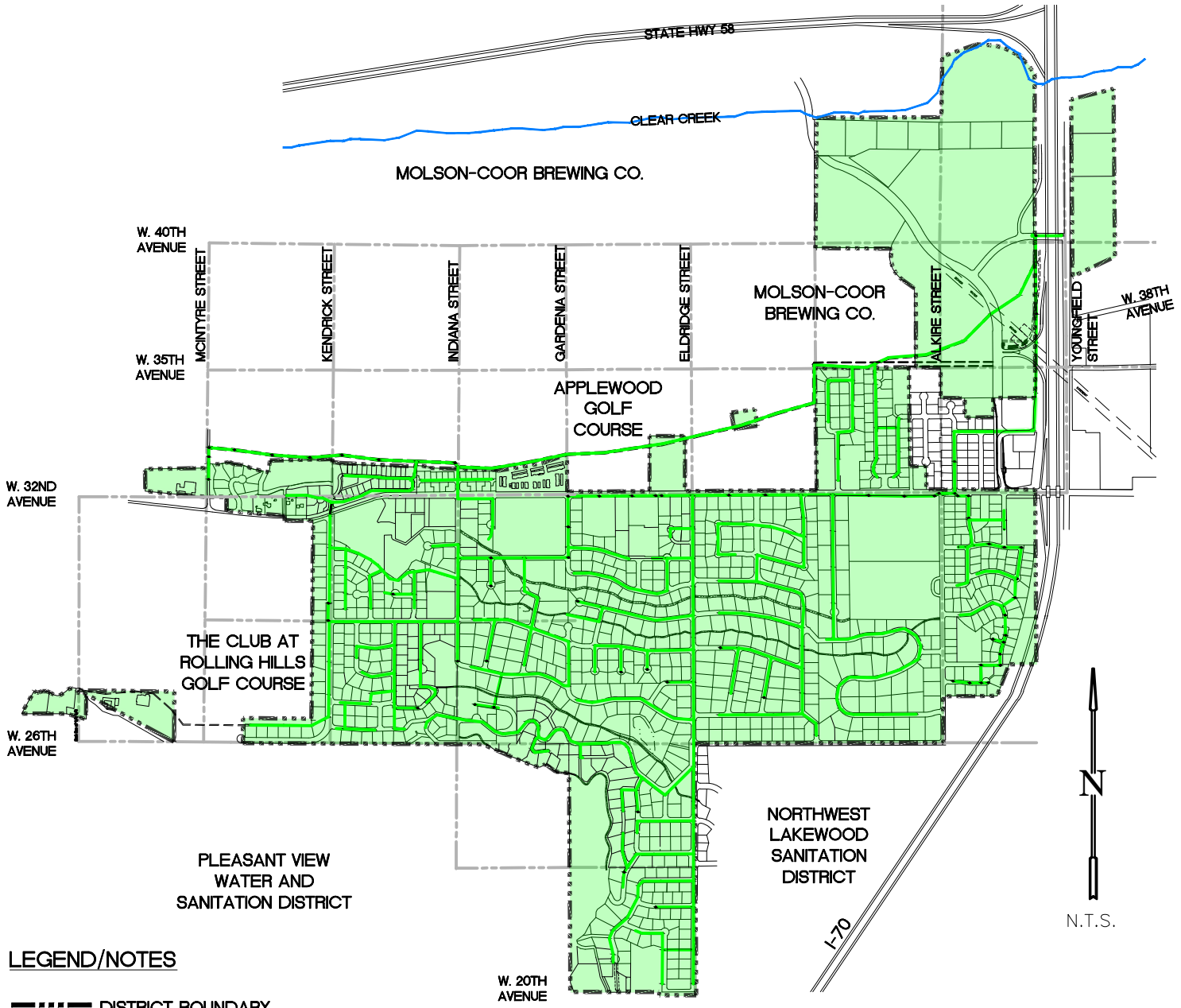

LEGEND/NOTES

- DISTRICT BOUNDARY
- DISTRICT MAINS
- GRID

DISTRICT DATA

AREA	777.6 Acres
POPULATION	* 2,550 Persons
LENGTH OF SEWER LINE	90,760 feet, 17.19 miles
NUMBER OF MANHOLES	396
	RESIDENCE = 998 NON-RESIDENT = 11
NUMBER OF CONNECTIONS	1,009
NUMBER OF EQUIV. RES. UNITS	1,067
CURRENT AS OF	December, 2018

THE DISTRICT INCLUDES PART OF THE FOLLOWING SECTIONS: SEC. 20, 29, 30 + 31, T3S, R69W AND SEC. 25, T3S, R70W

*POPULATION BASED ON 2.5 RESIDENTS PER ADDRESS

RG AND ASSOCIATES, LLC
 4885 Ward Road, Suite 100 • Wheat Ridge, CO • 80033
 Dillon • Del Norte • Wheat Ridge
 303-293-8107 • www.rgengineers.com